

# Gas springs - standard adjustable

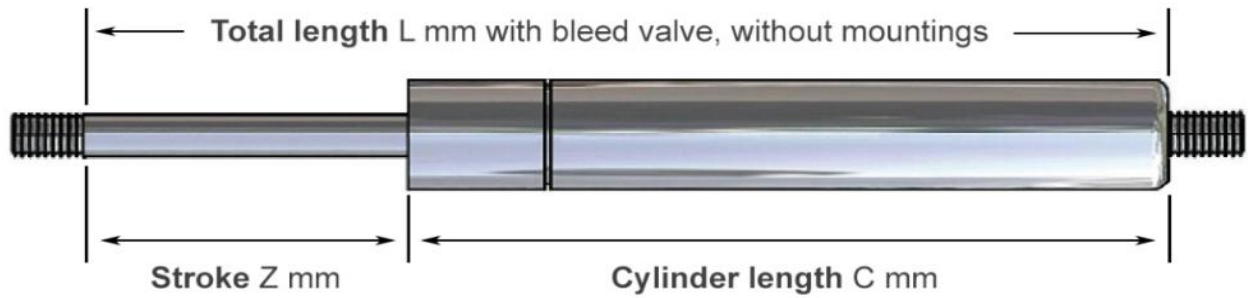

Art.nr	Size	Stroke Z	Cylinder length C	Total length L	Force
06-15-060VVV	6-15	60	103	163	Max 400N
06-15-100VVV	6-15	100	142	242	Max 400N
06-15-150VVV	6-15	150	197	347	Max 400N
06-15-200VVV	6-15	200	248	448	Max 400N
08-18-100VVV	8-18	100	150	250	Max 850N
08-18-150VVV	8-18	150	197	347	Max 850N
08-18-200VVV	8-18	200	250	450	Max 850N
08-18-250VVV	8-18	250	313	563	Max 850N
10-23-100VVV	10-23	100	148	248	Max 1200N
10-23-200VVV	10-23	200	245	445	Max 1200N
10-23-250VVV	10-23	250	295	545	Max 1200N
10-23-300VVV	10-23	300	345	645	Max 1200N
10-23-400VVV	10-23	400	450	850	Max 1200N
14-28-200VVV	14-28	200	260	460	Max 2500N
14-28-300VVV	14-28	300	360	660	Max 2500N
14-28-400VVV	14-28	400	460	860	Max 2500N
14-28-500VVV	14-28	500	560	1060	Max 2500N

## Mountings

Size	Thread	Thread size	Suitable mountings, see next page
6-15	S6	M5	P1, E1, P2, F1, C1
8-18	S8	M6	P5, E3, B2, Z2, F2, C2
10-23	S1	M8	B4, Z5, F4, C3
14-28	S4	M10	B6, FD, Z5



**\*STAINLESS STEEL DESIGN**

**BALL JOINT  
NYLON**

	P2	P5	PA	PE*	PW*
J (+/-)	9.0mm 0.5mm	14.0mm 0.5mm	14.0mm 0.5mm	9.0mm 0.25mm	12.0mm
K (+/-)	10.3mm 0.25mm	9.0mm 0.5mm	9.0mm 0.2mm	10.3mm 0.25mm	12.5mm
G	M5x0.8	M5x0.8	M5x0.8	M5x0.8	M8x1.25
C	M5x0.8	M5x0.8	M6x1.0	17.5mm 0.5mm	18.0MM
L (+/-)	17.5mm 0.5mm	17.5mm 0.5mm	17.5mm 0.5mm	M5x0.8	M6x1.0

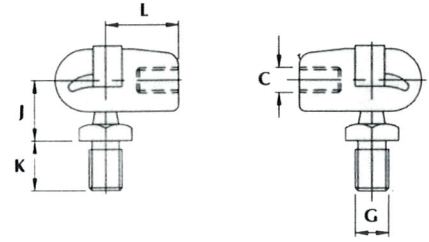

**NYLON EAR**

	E1	E2	E3	E4	E5
E (+/-)	6.1mm 0.08mm	7.35mm 0.05mm	8.1mm 0.05mm	6.1mm 0.05mm	10.1mm 0.05mm
M (+/-)	8.1mm 0.05mm	7.0mm 0.2mm	10.0mm 0.12mm	10.0mm 0.12mm	10.0mm 0.12mm
L (+/-)	17.0mm 0.5mm	17.0mm 0.5mm	21.0mm 0.25mm	21.0mm 0.25mm	21.0mm 0.25mm
C	M5x0.8	M5x0.8	M6x1.0	M6x1.0	M6x1.0

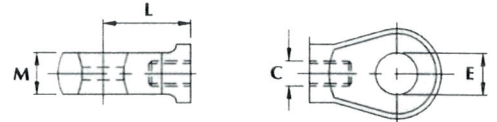

**FLAT EAR  
STEEL**

	F1	F2	F3	F4	FD	J1*	J2*
E (+/-)	6.1mm 0.12mm	8.1mm 0.12mm	10.2mm 0.12mm	8.2mm 0.12mm	10.0mm 0.036mm	8.0mm 0.036mm	8.0mm 0.036mm
M (+/-)	3.0mm 0.12mm	5.0mm 0.12mm	5.0mm 0.12mm	8.0mm 0.12mm	10.0mm 0.12mm	5.12mm 0.12mm	8.12mm 0.12mm
L (+/-)	22.0mm 0.25mm	25.0mm 0.25mm	25.0mm 0.25mm	32.0mm 0.25mm	32.0mm 0.25mm	25.0mm +/-0.25	32.0mm +/-0.25
C	M5x0.8	M6x1.0	M6x1.0	M8x1.25	M10x1.5	M6x1.0	M8x1.25

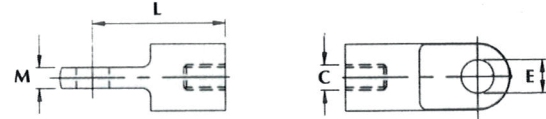

**FORK  
STEEL**

	C1	C2	C3	C4	H1*	H2*
E (+/-)	5.0mm 0.25mm	6.0mm 0.25mm	8.0mm 0.25mm	10.0mm 0.25mm	6.0mm 0.03mm	8.0mm 0.03mm
M (+/-)	5.14mm 0.12mm	6.15mm 0.12mm	5.15mm 0.12mm	10.15mm 0.12mm	6.25mm +/-0.10	8.27mm 0.12mm
L (+/-)	20.0mm 0.5mm	24.0mm 0.5mm	32.0mm 0.5mm	37.0mm 0.5mm	24.0mm +/-0.25mm	32.0mm +/-0.25mm
C	M5x0.8	M6x1.0	M8x1.25	M10x1.5	M6x1.0	M8x1.25

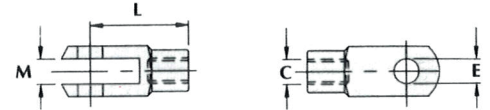

**BALL JOINT  
STEEL**

	B1	B2	B3	B4	B5	B6	G1*	G5*
J (+/-)	12.0mm 0.5mm	12.0mm 0.5mm	10.0mm 0.5mm	13.0mm 0.2mm	13.0mm 0.25mm	16.0mm 0.25mm	12.0mm 0.3mm	13.0mm 0.3mm
K (+/-)	9.0mm 0.3mm	12.5mm 0.5mm	12.5mm 0.5mm	16.5mm 0.5mm	16.5mm 0.5mm	20.0mm 0.5mm	12.5mm 0.3mm	16.5mm 0.3mm
G	M5x0.8	M8x1.25	5/ 16"UNC	M8x1.25	5/ 16"UNC	M10x1.5	M8x1.25	M8x1.25
L (+/-)	18.0mm 0.25mm	18.0mm 0.25mm	18.0mm 0.25mm	30.0mm 0.25mm	30.0mm 0.25mm	35.0mm 0.3mm	18.0mm 0.3mm	30.0mm 0.3mm
C	M6x1.0	M6x1.0	M6x1.0	M8x1.25	M8x1.25	M10x1.5	M6x1.0	M8x1.25

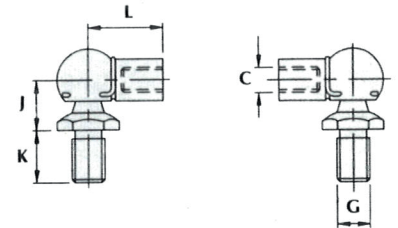

**ZINK EAR**

	Z2	Z3	Z4	Z5
E (+/-)	8.3mm 0.1mm	10.3mm 0.1mm	8.3mm 0.1mm	10.3mm 0.1mm
M (+/-)	10.0mm 0.12mm	10.0mm 0.12mm	10.0mm 0.12mm	10.0mm 0.12mm
L (+/-)	21.0mm 0.25mm	21.0mm 0.25mm	21.0mm 0.25mm	21.0mm 0.25mm
C	M6x1.0	M6x1.0	M8x1.25*	M8x1.25*

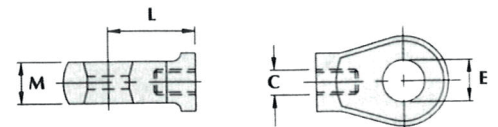

\*cannot be used on size 14-28

**THREAD  
SIZE**

	S1	S2	S4	S6	S8
M	M8x1.25	M10x1.5	M10x1.5	M5x0.8	M6x1.0
L	12mm	15mm	12mm	10mm	10mm

