

Gas springs - stainless adjustable

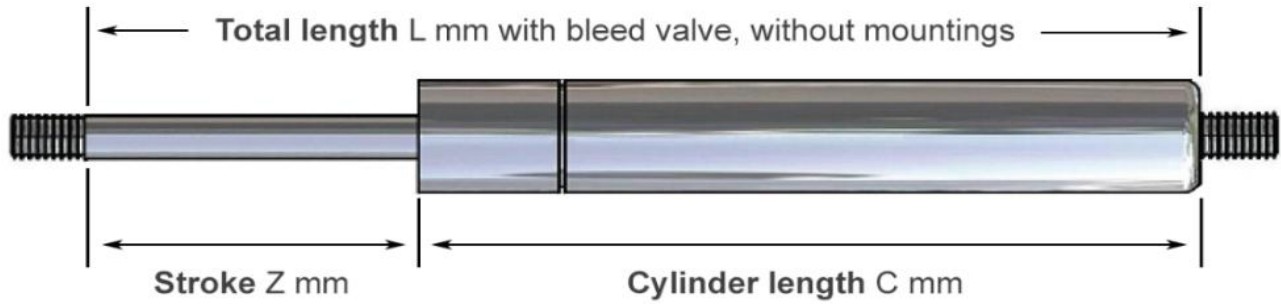

Art.nr	Size	Stroke Z	Cylinder length C	Total length L	Force
SXY6PV5099PVL	6-15	50	94	144	Max 400N
SXY6PV100149PVL	6-15	100	142	242	Max 400N
SXY6PV150199PVL	6-15	150	200	350	Max 400N
SXV8060600026293	8-18	100	150	250	Max 850N
SXV8060600026294	8-18	150	189	339	Max 850N
SXV8060600026295	8-18	200	240	440	Max 850N
SXV8060600026296	8-18	250	298	548	Max 850N

Mountings

Size	Thread	Thread Size	Suitable mountings, see next page
6-15	S6	M5	PE, E1, E2
8-18	S8	M6	PW, J1, H1, G1



Navestadsgatan 42
603 66 Norrköping
011-36 71 00
www.limo.se

***STAINLESS STEEL DESIGN**

**BALL JOINT
NYLON**

	P2	P5	PA	PE*	PW*
J (+/-)	9.0mm 0.5mm	14.0mm 0.5mm	14.0mm 0.5mm	9.0mm 0.25mm	12.0mm
K (+/-)	10.3mm 0.25mm	9.0mm 0.5mm	9.0mm 0.2mm	10.3mm 0.25mm	12.5mm
G	M5x0.8	M5x0.8	M5x0.8	M5x0.8	M8x1.25
C	M5x0.8	M5x0.8	M6x1.0	17.5mm 0.5mm	18.0MM
L (+/-)	17.5mm 0.5mm	17.5mm 0.5mm	17.5mm 0.5mm	M5x0.8	M6x1.0

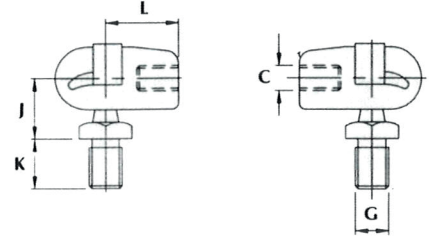

NYLON EAR

	E1	E2	E3	E4	E5
E (+/-)	6.1mm 0.08mm	7.35mm 0.05mm	8.1mm 0.05mm	6.1mm 0.05mm	10.1mm 0.05mm
M (+/-)	8.1mm 0.05mm	7.0mm 0.2mm	10.0mm 0.12mm	10.0mm 0.12mm	10.0mm 0.12mm
L (+/-)	17.0mm 0.5mm	17.0mm 0.5mm	21.0mm 0.25mm	21.0mm 0.25mm	21.0mm 0.25mm
C	M5x0.8	M5x0.8	M6x1.0	M6x1.0	M6x1.0

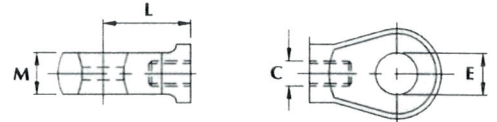

**FLAT EAR
STEEL**

	F1	F2	F3	F4	FD	J1*	J2*
E (+/-)	6.1mm 0.12mm	8.1mm 0.12mm	10.2mm 0.12mm	8.2mm 0.12mm	10.0mm 0.036mm	8.0mm 0.036mm	8.0mm 0.036mm
M (+/-)	3.0mm 0.12mm	5.0mm 0.12mm	5.0mm 0.12mm	8.0mm 0.12mm	10.0mm 0.12mm	5.12mm 0.12mm	8.12mm 0.12mm
L (+/-)	22.0mm 0.25mm	25.0mm 0.25mm	25.0mm 0.25mm	32.0mm 0.25mm	32.0mm 0.25mm	25.0mm +/-0.25	32.0mm +/-0.25
C	M5x0.8	M6x1.0	M6x1.0	M8x1.25	M10x1.5	M6x1.0	M8x1.25

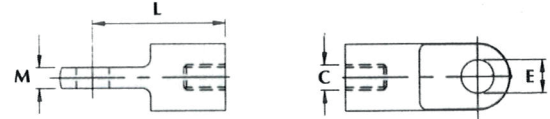

**FORK
STEEL**

	C1	C2	C3	C4	H1*	H2*
E (+/-)	5.0mm 0.25mm	6.0mm 0.25mm	8.0mm 0.25mm	10.0mm 0.25mm	6.0mm 0.03mm	8.0mm 0.03mm
M (+/-)	5.14mm 0.12mm	6.15mm 0.12mm	5.15mm 0.12mm	10.15mm 0.12mm	6.25mm +/-0.10	8.27mm 0.12mm
L (+/-)	20.0mm 0.5mm	24.0mm 0.5mm	32.0mm 0.5mm	37.0mm 0.5mm	24.0mm +/-0.25mm	32.0mm +/-0.25mm
C	M5x0.8	M6x1.0	M8x1.25	M10x1.5	M6x1.0	M8x1.25

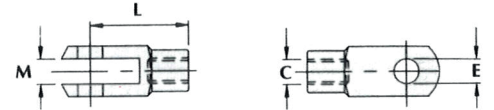

**BALL JOINT
STEEL**

	B1	B2	B3	B4	B5	B6	G1*	G5*
J (+/-)	12.0mm 0.5mm	12.0mm 0.5mm	10.0mm 0.5mm	13.0mm 0.2mm	13.0mm 0.25mm	16.0mm 0.25mm	12.0mm 0.3mm	13.0mm 0.3mm
K (+/-)	9.0mm 0.3mm	12.5mm 0.5mm	12.5mm 0.5mm	16.5mm 0.5mm	16.5mm 0.5mm	20.0mm 0.5mm	12.5mm 0.3mm	16.5mm 0.3mm
G	M5x0.8	M8x1.25	5/ 16"UNC	M8x1.25	5/ 16"UNC	M10x1.5	M8x1.25	M8x1.25
L (+/-)	18.0mm 0.25mm	18.0mm 0.25mm	18.0mm 0.25mm	30.0mm 0.25mm	30.0mm 0.25mm	35.0mm 0.3mm	18.0mm 0.3mm	30.0mm 0.3mm
C	M6x1.0	M6x1.0	M6x1.0	M8x1.25	M8x1.25	M10x1.5	M6x1.0	M8x1.25

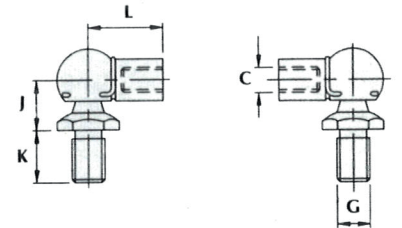

ZINK EAR

	Z2	Z3	Z4	Z5
E (+/-)	8.3mm 0.1mm	10.3mm 0.1mm	8.3mm 0.1mm	10.3mm 0.1mm
M (+/-)	10.0mm 0.12mm	10.0mm 0.12mm	10.0mm 0.12mm	10.0mm 0.12mm
L (+/-)	21.0mm 0.25mm	21.0mm 0.25mm	21.0mm 0.25mm	21.0mm 0.25mm
C	M6x1.0	M6x1.0	M8x1.25*	M8x1.25*

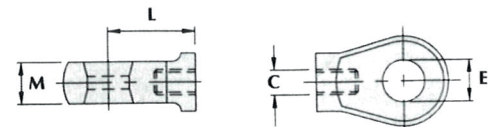

*cannot be used on size 14-28

**THREAD
SIZE**

	S1	S2	S4	S6	S8
M	M8x1.25	M10x1.5	M10x1.5	M5x0.8	M6x1.0
L	12mm	15mm	12mm	10mm	10mm

