

# JUBOFLEX “S”

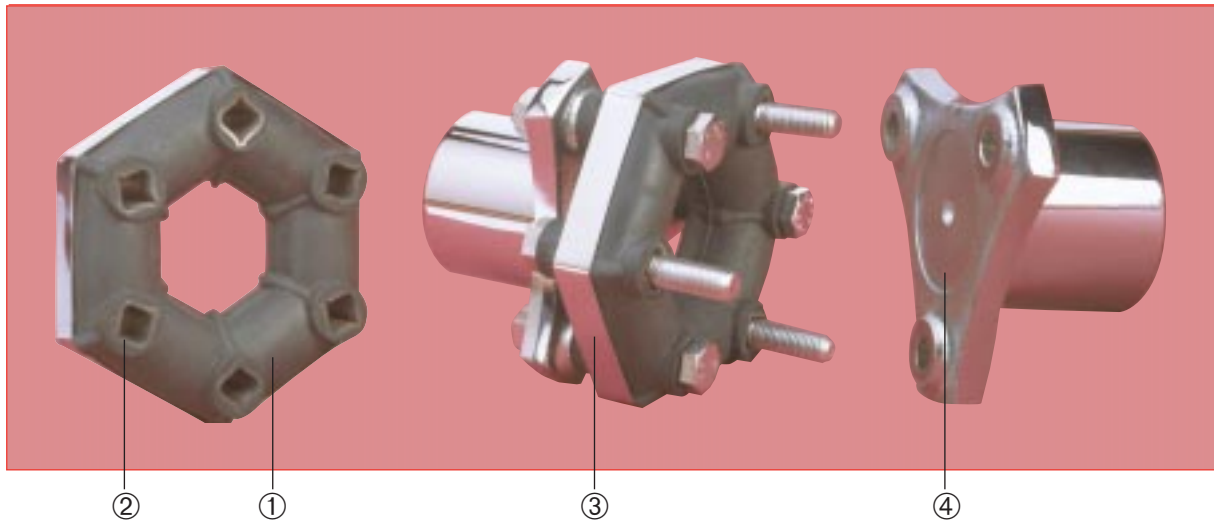

## DESCRIPTION

- Flexible element :
  - ① Precompressed natural rubber.
  - ② Bonded metal reinforcing mountings.
  - ③ Precompression band (to be removed after installation).
- Flange :
  - ④ Die-cast steel (except 632267 which is cast-iron).

## OPERATION

The JUBOFLEX “S” coupling is designed with the following features :

- Radial disassembly without moving the machines that are coupled.
- The flexible element is compressed during assembly, which extends the range of operating conditions where the rubber is not subject to tension.

### Advantages :

- JUBOFLEX “S” has a greater load capacity than the standard JUBOFLEX.
- Highly effective attenuation of cyclic irregularities and peaks in the torque.
- Due to the precompression, the JUBOFLEX “S” has very good resistance to torsional peaks.
- Tolerance to large misalignment : avoids the need for precise alignment of the machines to be coupled.

### Recommendation :

- In use, precompression is achieved by the fixing bolts, and the JUBOFLEX “S” coupling operates without the precompression band round the flexible element.

## DIMENSIONS

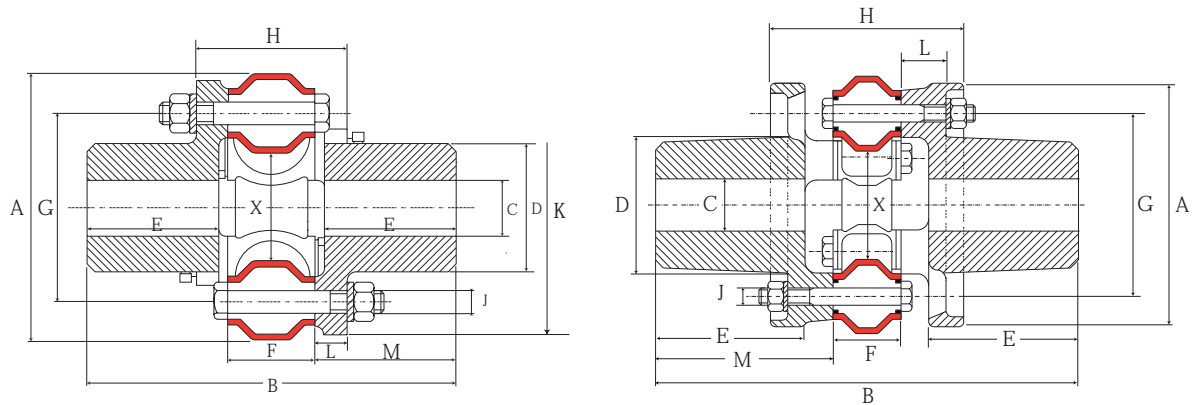

**JUBOFLEX Steel flanges except 632267**    **JUBOFLEX Cast-iron flanges : ref. 632267**

Nominal torque N.m	Vibrat. torque N.m	Max torque N.m	Max speed rpm	Hole size C mm		A mm	B mm	D mm	E mm	Reference (without protector)	F mm	G mm	H mm	J mm	K mm	L mm	M mm	X* mm	Weight kg
				mini	max														
60	30	120	6000		30	91	128	42	47	<b>632260</b>	28	65	50	8	87	11	50	23	2
130	65	270	5000		40	117	172	56	66	<b>632261</b>	32	85	60	10	113	14	70	35	3
240	120	480	4500		48	142	196	68	70	<b>632262</b>	46	100	80	12	135	17	75	40	5
370	185	750	3500		60	181	247	90	93	<b>632263</b>	51	132	93	14	172	21	98	63	12
520	260	1050	3000		70	202	284	105	109	<b>632264</b>	54	150	96	18	196	21	115	68	18
750	375	1500	2800		75	232	322	115	124	<b>632265</b>	62	170	108	20	225	23	130	75	25
1050	525	2100	2400		80	263	346	122	133	<b>632266</b>	68	190	116	20	246	24	139	82	32
1800	900	3600	2400	60	100	280	486	156	172	<b>632267</b>	78	210	222	20	-	52	204	110	57

1 Nm  $\neq$  0.1 mkg

See current price list for availability of items.

The maximum torque is considered to be an infrequent start-up torque and is not periodic.

## PARTS LIST

The flexible elements are delivered precompressed using a precompression band which should be removed after installation.

For subsequent maintenance, use the disassembly band shown in the parts list.

Coupling without protector	Reference	Qty	Flange reference	Qty	Disassembly band reference
<b>632262</b>	<b>632552</b>	1	321334	2	331243
<b>632261</b>	<b>632551</b>	1	321324	2	331242
<b>632266</b>	<b>632556</b>	1	321364	2	331246
<b>632260</b>	<b>632550</b>	1	321314	2	331241
<b>632263</b>	<b>632553</b>	1	321344	2	331244
<b>632264</b>	<b>632554</b>	1	321354	2	331245
<b>632265</b>	<b>632555</b>	1	321374	2	331247
<b>632267</b>	<b>632557*</b>	1	321390	2	331240

\* This element has 8 mounting holes.

